

## WIPL-D Pro V17

*... where 3D EM  
modeling meets  
accuracy and  
efficiency*

**New:**

# released!

- Full exploitation of Matrix Symmetry:
  - Reduced matrix fill time
  - Reduced matrix solution time
- Improved GPU out-of-core solution:
  - Matrix fill in parallel on multiple hard disks
- Accelerated GPU matrix fill: up to 40%
- New functionalities in massive RCS calculation ("Run As Avoided with Interpolation")
  - Support for 3D angular interpolation
  - Refined interpolation by Spline function
  - New interpolation function: Rational function
  - Error estimation
- Refined accuracy of Periodic Boundary Condition
- Sweep parallel run
  - Concurrent simulation of multiple sub projects
- Fast calculation of excitation matrix for Field Generators' arrays
- STL editor
  - Import of STL files
  - Variety of edit options
  - Decimation
  - Quadrilateral meshing
  - Export to STL files
- Accelerated Topological Analysis
- Easier handling of (very) complex structures
  - Hide Selected Plates
  - Select Layer
  - Extended limits for "Manipulations"
  - Fast Open/Save/Save As

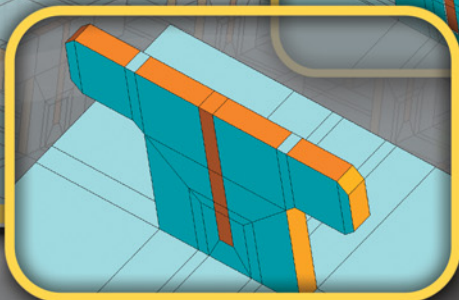
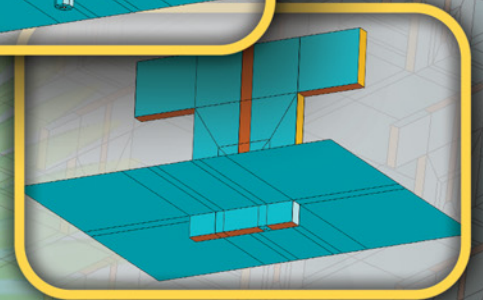
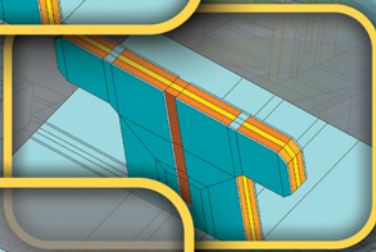
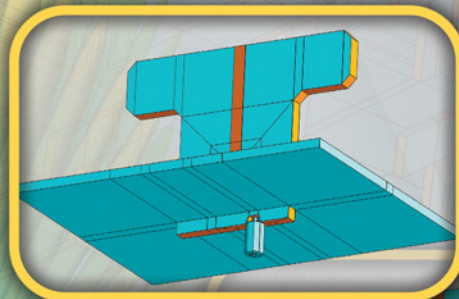
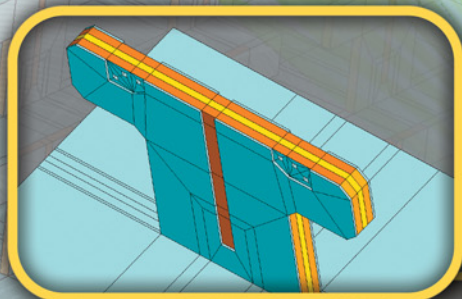

### Features:

- Full 3D EM simulation in frequency domain
- Metallic, dielectric and magnetic materials
- Lumped elements and distributed loadings
- Add-ons: GPU Solver, Optimizer, Time Domain Solver, Circuit Solver (Microwave) and 2D Solver
- Applications: antenna design and placement, scatterers, microwave circuits and waveguides, EMC ...